

Digital CROS/BiCROS

Passport™/Yuu™/Next™/360™

Passport™, Yuu™, Next™, 360™

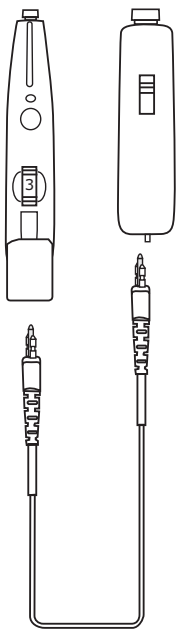

CROS mode:

Attach audio input battery door unit to hearing instrument (see instructions below). Connect cord to battery door unit and to offside microphone unit. Program hearing aid in U:Fit™ by selecting Direct Audio Input environment and DAI input option on the Quick Fit screen.

BiCROS mode:

Attach audio input battery door unit to hearing instrument (see instructions below). Connect cord to battery door unit and to offside microphone unit. Program hearing aid in U:Fit by selecting Direct Audio Input environment and Mic + DAI input option on the Quick Fit screen.

Note:

- Cords are available in multiple lengths

Attaching the audio input battery door unit to Passport™, Yuu™ and Next™

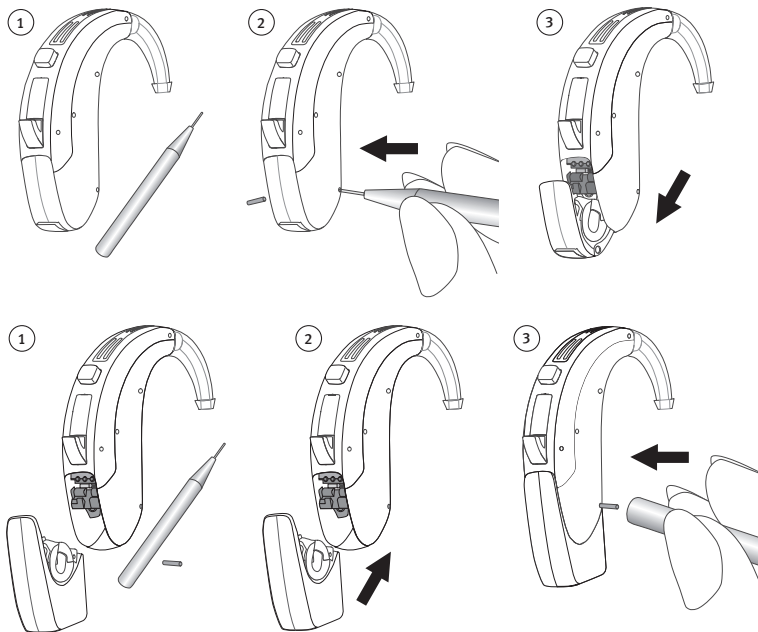

Attaching the audio input battery door unit to 360™

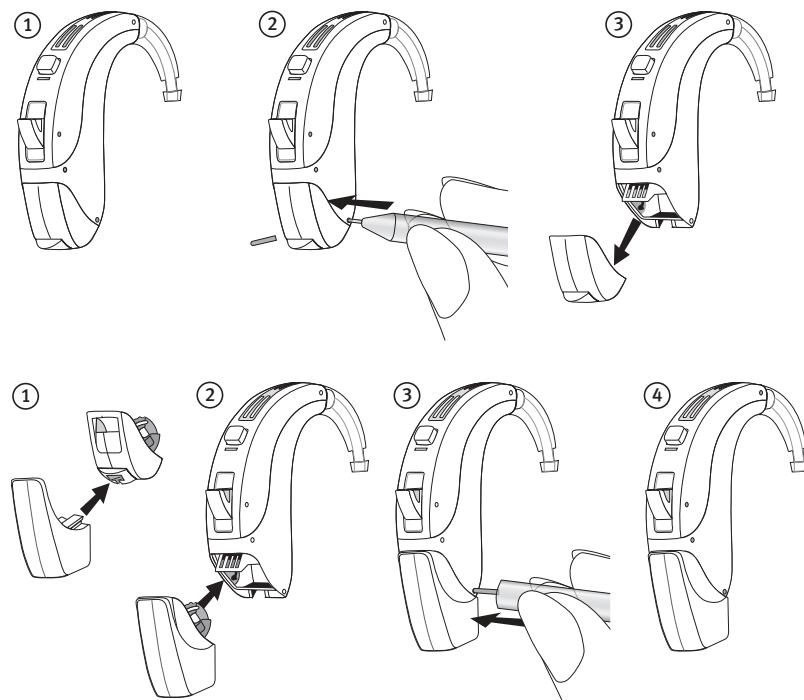

Microphone Unit, Cords and Shoes for all Digital Series

Model	Microphone Unit	Shoes/Boots	Cords
Passport Yuu Next 16/8/4/E CROS	<ul style="list-style-type: none"> • 1 microphone unit required • Available in beige • No battery required in microphone unit • 054-0306-01 	<ul style="list-style-type: none"> • 1 BTE with optional direct audio input battery door unit required • Available in clear or beige • Audio shoe part # 054-5201-01 / 054-5201-13 	<ul style="list-style-type: none"> • 1 CROS/BiCROS type B cord required • Choice of lengths (<i>see below</i>)
Passport Yuu Next 16/8/4/E BiCROS	<ul style="list-style-type: none"> • 1 microphone unit required • Available in beige • No battery required in microphone unit • 054-0306-01 	<ul style="list-style-type: none"> • 1 BTE with optional direct audio input battery door unit required • Available in clear or beige • Audio shoe part # 054-5201-01 / 054-5201-13 	<ul style="list-style-type: none"> • 1 CROS/BiCROS type B cord required • Choice of lengths (<i>see below</i>)
360+ 360e CROS	<ul style="list-style-type: none"> • 1 microphone unit required • Available in beige • No battery required in microphone unit • 054-0306-01 	<ul style="list-style-type: none"> • 1 BTE with optional direct audio input battery door unit required • Available in clear or beige • Audio boot part # 054-5224-01 / 054-5224-13 	<ul style="list-style-type: none"> • 1 CROS/BiCROS type B cord required • Lengths (<i>see below</i>)
360+ 360e BiCROS	<ul style="list-style-type: none"> • 1 microphone unit required • Available in beige • No battery required in microphone unit • 054-0306-01 	<ul style="list-style-type: none"> • 1 BTE with optional direct audio input battery door unit required • Available in clear or beige • Audio boot part # 054-5224-01 / 054-5224-13 	<ul style="list-style-type: none"> • 1 CROS/BiCROS type B cord required • Lengths (<i>see below</i>)

Cord Lengths:

Type B	20 cm/7.87"	22.5 cm/8.59"	25 cm/9.84"	27.5 cm/10.83"
Part number	057-0100	057-0064	057-0101	057-0065

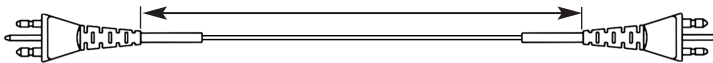

NOTE: Cord length measurement should be made from ear to ear, behind the head.

